



If the plastic caps on your clothes bar has broken, it is an easy repair to replace the caps while using the same bar –

1. Remove the Philip Head screw on the broken side of the bar (save them for reinstallation) which is located on the bottom side of the clothes bar (see picture below, left).
2. If part of the plastic cap is accessible (sticking out of the bar enough to grab it), pull it out with pliers. If it's broken and flush with the end of the bar like the pictures shown below, push the remaining piece further into the bar with a screw driver (see middle and right pictures below).
3. Insert the replacement pole cap.
4. insert the same screws.



Screw



Example of broken cap inside clothes bar

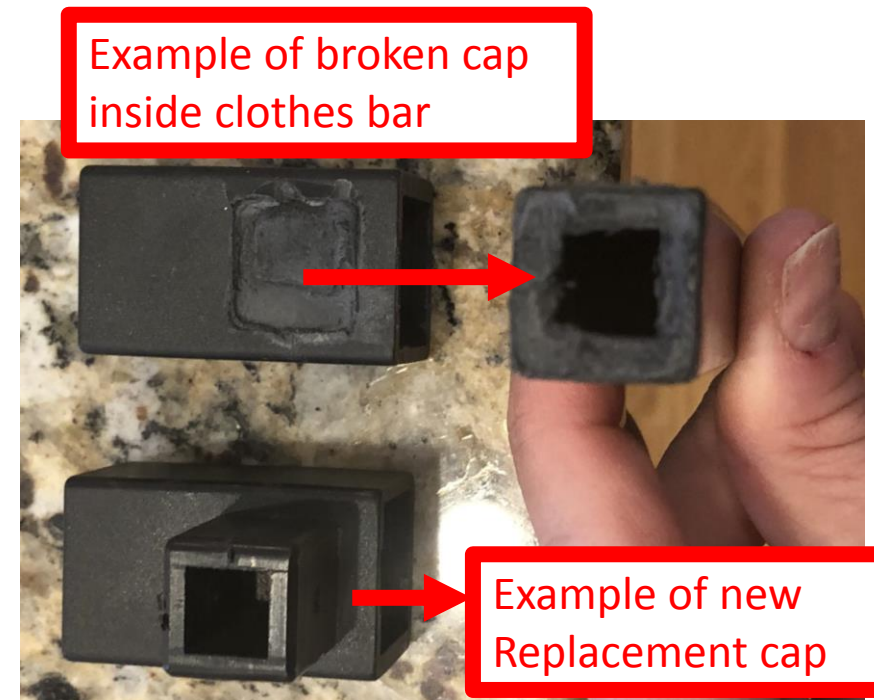

Example of broken cap inside clothes bar

Example of new Replacement cap